

DELETED SECTIONS

- 12, 15, 17, 18, 22,
23, 24, 25, 26,
27, 28, 29, 31,
32, 33,

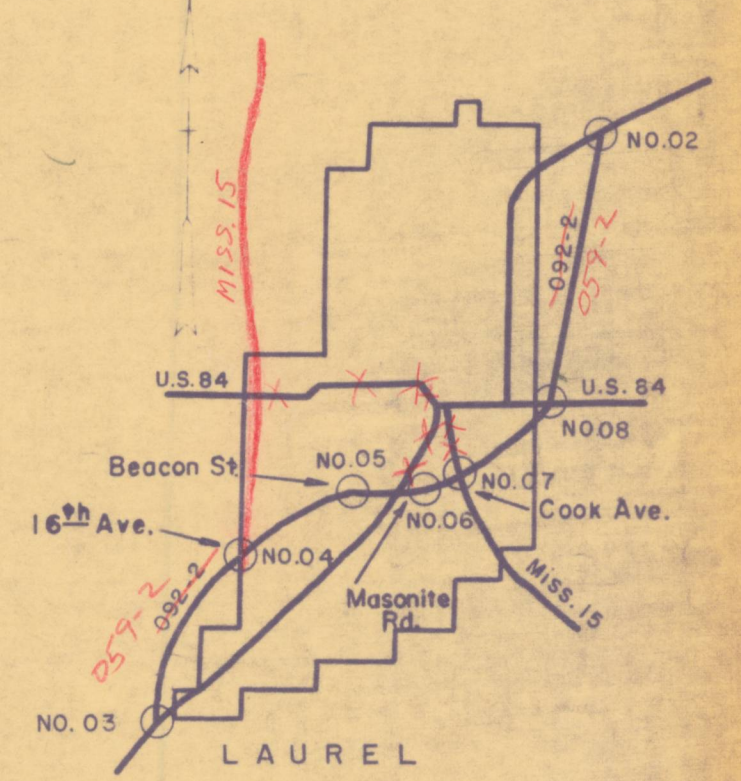
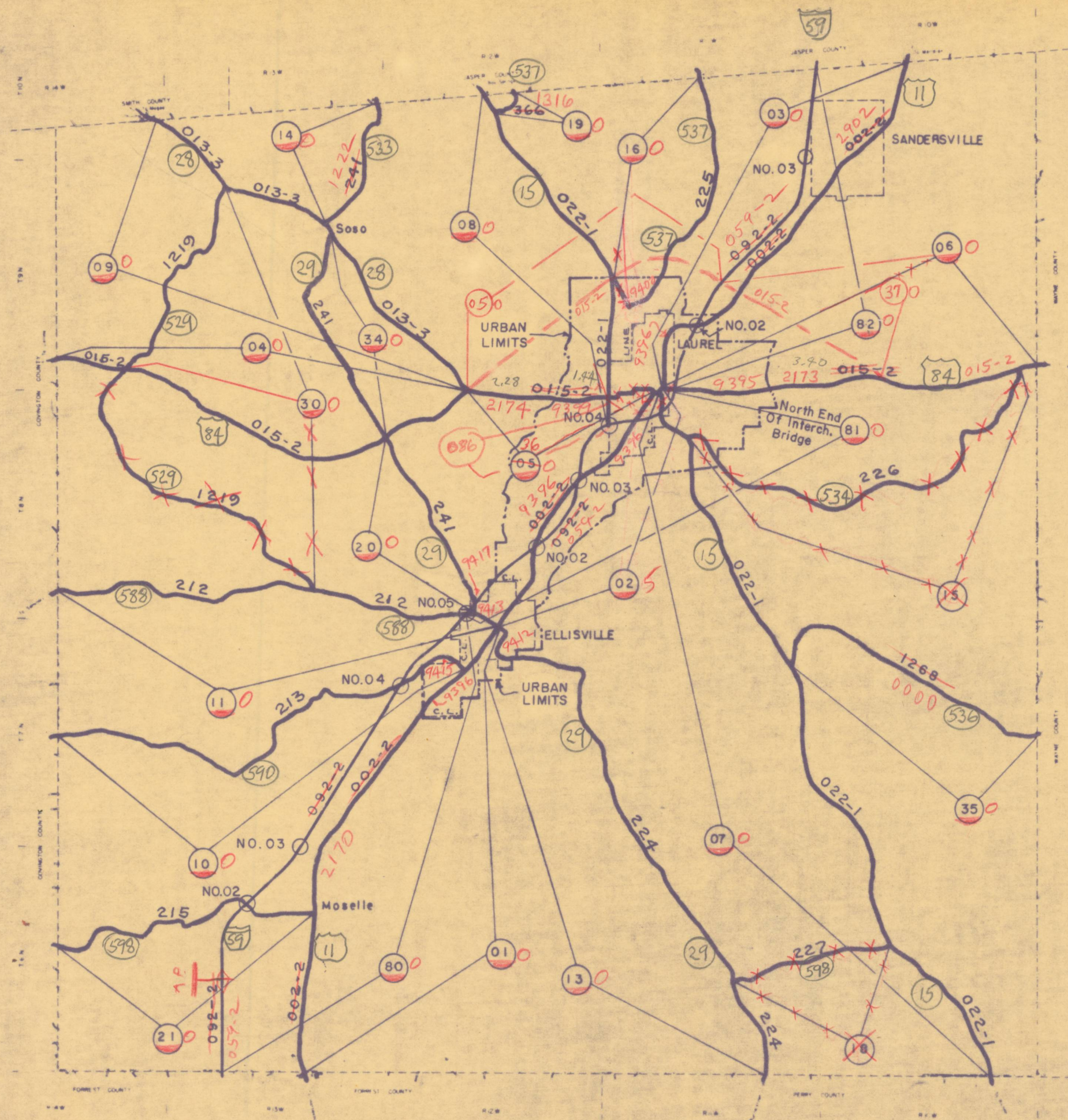

JONES COUNTY MISSISSIPPI

PREPARED BY THE
MISSISSIPPI STATE HIGHWAY DEPARTMENT
TRAFFIC AND PLANNING DIVISION
IN COOPERATION WITH THE
U.S. DEPARTMENT OF COMMERCE
BUREAU OF PUBLIC ROADS
DATA OBTAINED FROM
TRAFFIC AND PLANNING SURVEY
AND
AERIAL PHOTOGRAPHS

LAST NO. USED

37

EXCEPT FOR I-S
82

C-2
(M-D 6) 34